

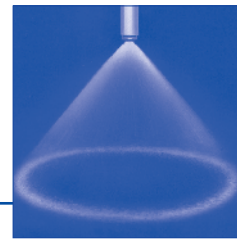

## Tangential Nozzles

### Series 300.185



**Very homogeneous and stable hollow cone spray pattern. Not prone to clogging due to tangential design.**

**Applications:**

Acid regeneration.

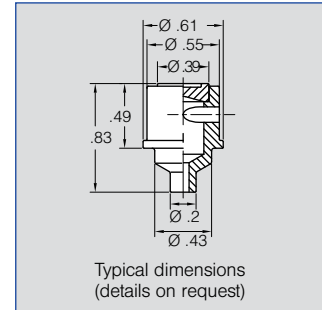

For the acid regeneration a very precise spray pattern even at low flow rates is required.

The nozzles are fitted in a plate with multiple borings allowing the flow to pass through to the nozzles and to position them correctly.

Special materials such as sintered silicon carbide or aluminium oxide are used for the nozzles to prolong the life-time in this demanding atmosphere.

Please contact Lechler for available flow rates and spray angles.



Schematic view of reactor