



Flat fan nozzles

Series 625



Parabolic distribution of liquid. Headers, equipped with these nozzles, show a highly uniform total distribution of liquids, even at different installation heights and centers.

Applications:

Cleaning, pickling, surface treatment, rinsing.

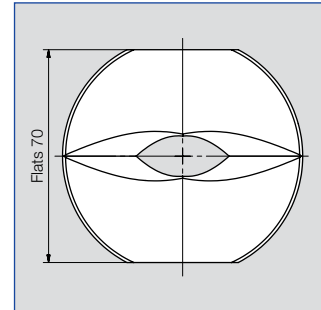
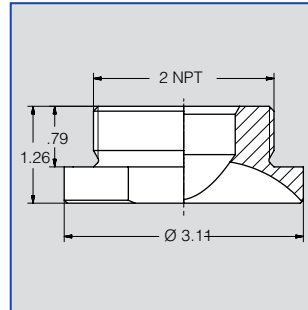

| Spray angle  | Ordering no. | | Equivalent Orifice diam. [in] | Free passage [in] | Flow Rate (Gallons Per Minute) | | | | | | | Spray width B at p=30 psi | | |
|--|--------------|----------|-------------------------------|-------------------|--------------------------------|--------|--------|--------|-------------------|-------|---------|---------------------------|-------|-------|
| | Type | Mat. no. | | | 10 psi | | 20 psi | | liters per minute | | 100 psi | | H=10" | H=20" |
| | | 5E | | | 2 bar | 40 psi | 60 psi | 80 psi | 100 psi | | | | | |
| 20° | 625. 301 | ○ | .630 | .520 | 23.8 | 33.5 | 180 | 58.1 | 75.3 | 89.0 | 106.2 | 5 | 8 | |
| | 625. 321 | ○ | .669 | .559 | 26.4 | 37.2 | 200 | 64.7 | 83.5 | 98.8 | 118.1 | 5 | 8 | |
| | 625. 361 | ○ | .748 | .642 | 33.0 | 46.8 | 250 | 80.8 | 104.3 | 123.6 | 147.7 | 5 | 8 | |
| | 625. 421 | ○ | .886 | .756 | 48.3 | 68.2 | 365 | 118.1 | 152.4 | 180.4 | 215.6 | 5 | 8 | |
| | 625. 451 | ○ | .965 | .823 | 56.3 | 79.5 | 425 | 137.6 | 177.5 | 210.0 | 251.0 | 5 | 8 | |
| 60° | 625. 404 | ○ | .827 | .520 | 41.7 | 58.9 | 315 | 102.0 | 131.6 | 155.6 | 186.0 | 13 | 25 | |
| | 625. 454 | ○ | .965 | .638 | 56.3 | 79.5 | 425 | 137.6 | 177.5 | 210.0 | 251.0 | 13 | 25 | |
| 120° | 625. 367 | ○ | .748 | .591 | 33.0 | 46.8 | 250 | 80.8 | 104.3 | 123.6 | 147.7 | 32 | 57 | |
| | 625. 407 | ○ | .827 | .709 | 41.7 | 58.9 | 315 | 102.0 | 131.6 | 155.6 | 186.0 | 32 | 57 | |
| | 625. 427 | ○ | .886 | .709 | 48.3 | 68.2 | 365 | 118.1 | 152.4 | 180.4 | 215.6 | 32 | 57 | |

Incl. gasket 062.540.72.00 (Material: EWP 210)

| | | | | | |
|-----------------------------|-------------|----------|---------------------|----------|---------------------|
| Example of ordering: | Type | + | Material no. | = | Ordering no. |
| | 625. 301 | + | 5E | = | 625. 301. 5E |