

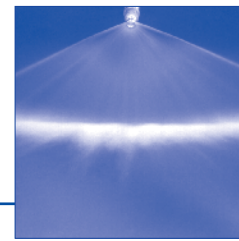

Tongue-type nozzles

Series 686



Wide flat fan with a sharply delimited jet pattern. Non-clogging.

Applications:

Cleaning, pickling, rinsing, requiring powerful and concentrated water jets.

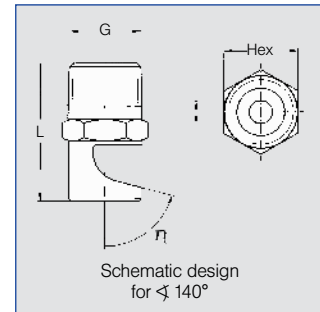

Spray angle 	η	Ordering no.								Orifice diameter [in]	Flow Rate (Gallons Per Minute)			Dimensions								Spray width B at p=30 psi H=10"
		Mat. no.		Code G				Type	L [in]			Hex [in]										
		17 ¹	5E	Connection					R		R	R	R	R	R	R	R					
		AISI 316Ti/ AISI 316L	PVDF	Male NPT																		
				1/8"	1/4"	3/8"	1/2"		14.5	2.0	72.5	1/8	1/4	3/8	1/2	1/8	1/4	3/8	1/2			
90°	40°	686. 646	○	-	BA	-	-	-	.087	.75	4.0	1.7	.97	-	-	-	.43	-	-	-	21	
		686. 686	○	-	BA	BC	-	-	.094	.94	5.0	2.1	.98	1.6	-	-	.43	.55	-	-	21	
		686. 726	○	-	-	BC	-	-	.106	1.2	6.3	2.6	-	1.2	-	-	-	.55	-	-	21	
		686. 766	○	-	-	BC	-	-	.118	1.5	8.0	3.3	-	1.3	-	-	-	.55	-	-	21	
		686. 806	○	○	-	BC	-	-	.134	1.9	10.0	4.2	-	1.3	-	-	-	.55	-	-	21	
		686. 846	○	-	-	BC	BE	-	-	.150	2.3	12.5	5.2	-	1.3	1.3	-	-	.55	.67	-	21
		686. 846	-	○	-	BC	-	-	.150	2.3	12.5	5.2	-	1.3	-	-	-	.55	-	-	21	
		686. 886	○	-	-	BC	-	-	.165	3.0	16.0	6.7	-	1.4	-	-	-	.67	-	-	21	
		686. 926	○	-	-	-	BE	-	-	.185	3.7	20.0	8.4	-	-	1.5	-	-	-	.67	-	21
		686. 926	-	○	-	-	BE	BG	-	.185	3.7	20.0	8.4	-	-	1.5	1.7	-	-	.67	.87	21
		686. 966	-	○	-	-	-	BG	-	.209	4.7	25.0	10.4	-	-	-	1.81	-	-	-	.87	21
		686. 966	○	-	-	-	BE	BG	-	.209	4.7	25.0	10.4	-	-	1.6	1.8	-	-	.67	.87	21
686. 986	○	-	-	-	-	BG	-	.220	5.2	28.0	11.7	-	-	-	1.8	-	-	-	.87	21		
140°	75°	686. 648	○	-	-	BC	-	-	.087	.75	4.0	1.7	-	.95	-	-	-	.55	-	-	54	
		686. 688	○	-	BA	BC	-	-	.094	.94	5.0	2.1	.91	1.1	-	-	.43	.55	-	-	54	
		686. 728	○	-	BA	BC	-	-	.106	1.2	6.3	2.6	.91	1.1	-	-	.43	.55	-	-	54	
		686. 728	-	○	-	BC	-	-	.106	1.2	6.30	2.6	-	1.1	-	-	-	.55	-	-	54	
		686. 768	○	-	BA	BC	-	-	.118	1.5	8.00	3.3	.91	1.1	-	-	.43	.55	-	-	54	
		686. 808	○	-	BA	BC	-	-	.134	1.9	10.0	4.2	.91	1.1	-	-	.43	.55	-	-	54	
		686. 808	-	○	-	BC	-	-	.134	1.9	10.0	4.2	-	1.1	-	-	-	.55	-	-	54	
		686. 828	○	-	BA	BC	-	-	.142	2.1	11.2	4.7	.91	1.1	-	-	.43	.55	-	-	54	
		686. 848	○	-	BA	BC	-	-	.150	2.3	12.5	5.2	.91	1.1	-	-	.43	.55	-	-	54	
		686. 848	-	○	-	BC	-	-	.150	2.3	12.5	5.2	-	1.1	-	-	-	.55	-	-	54	
		686. 868	-	○	-	BC	-	-	.157	2.6	14.0	5.9	-	1.1	-	-	-	.55	-	-	54	
		686. 888	○	○	-	BC	-	-	.165	3.0	16.0	6.7	-	1.1	-	-	-	.55	-	-	54	
		686. 908	○	-	-	BC	BE	-	.177	3.4	18.0	7.5	-	1.1	1.2	-	-	.55	.67	-	54	
		686. 928	○	○	-	-	BE	-	.185	3.7	20.0	8.35	-	-	1.2	-	-	-	.67	-	54	
		686. 948	○	-	-	-	BE	-	.193	4.2	22.4	9.36	-	-	1.3	-	-	-	.67	-	54	
		686. 968	○	-	-	-	BE	BG	.209	4.7	25.0	10.44	-	-	1.3	1.5	-	-	.67	.87	54	
		686. 988	○	-	-	-	BE	BG	.220	5.2	28.0	11.69	-	-	1.3	1.5	-	-	.67	.87	54	

¹ We reserve the right to deliver AISI 316Ti or AISI 316L under the material no. 17.

Other types on request.

Example Type + Material no. + Conn. = Ordering no.
of ordering: 686. 646 + 17 + BA = 686. 646. 17. BA

Conversion formula for the above series: $V_2 = V_1 \sqrt{\frac{P_2}{P_1}}$