

# Rotating cleaning nozzle XactClean HP2

## Series 5S6/5S7



### Features:

- Flat fan nozzle with high impact
- Uniform cleaning
- High efficiency due to controlled rotation
- Suitable for use with steam

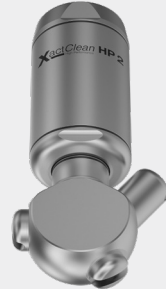

**ATEX version available on request**

Series 5S6/5S7

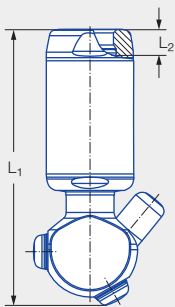

Female thread

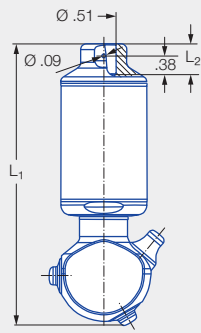

Dimensions of 1/2" slip-on connection according to ASME-BPE (OD tube)

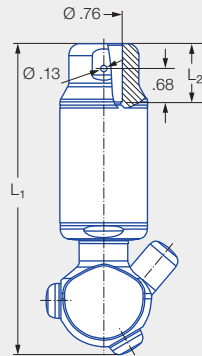

Dimensions of 3/4" slip-on connection according to ASME-BPE (OD tube)

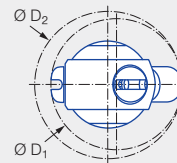

Insertion diameter  $D_1$  and interference circle diameter  $D_2$  of the threaded connection

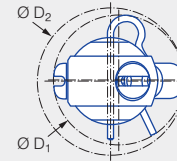

Insertion diameter  $D_1$  and interference circle diameter  $D_2$  of the slip-on connection

Max. tank diameter [ft]	0	5	10	20	25	30
-------------------------	---	---	----	----	----	----

### Technical data:



**Maximum operating temperature**  
302 °F



**Maximum ambient temperature**  
302 °F



**Installation**  
Operation in every installation position



**Bearing**  
Double ball bearing



**Material**  
Stainless steel 1.4404 (316L), PEEK, EPDM



**Weight**  
1.43lbs - 1.98lbs



**Surface quality Outside**  
 $Ra \leq 0.8 \mu m$



**Surface quality Inside**  
 $Ra \leq 1.6 \mu m$



**Steam suitability**  
Suitable



**Insertion diameter**  
3.19–5.51 in



**Recommended filter**  
Line strainer with a mesh size of 0.3 mm/50 mesh



**Recommended operating pressure**  
45 psi



**Adapter**  
3/8 BSPP, 1/2 BSPP, 3/4 BSPP and 1 BSPP are compatible with HygienicFit



**Rotation monitoring**  
Sensor-compatible, information: see pages 96–97





**Maintainable**



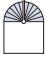
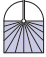

Connection		Dimensions [in]			
		L <sub>1</sub>	L <sub>2</sub>	Insertion diameter D <sub>1</sub>	Interference circle diameter D <sub>2</sub>
BF	3/8 NPT	5.55	0.35	1.97–2.60	1.97–2.64
BH	1/2 NPT	5.63	0.51	1.97–2.91	1.97–2.99
BL	3/4 NPT	5.63	0.52	1.97–3.11	1.97–3.19
BN	1 NPT	5.51	0.65	2.01–3.11	2.09–3.15
TF05	1/2" slip-on connection	5.91	0.63	2.05–2.60	1.97–2.64
TF07	3/4" slip-on connection	6.30	1.18	2.60–3.11	1.97–3.19

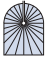
Spray angle	Type	Order number						Narrowest cross-section Ø [in]	V̇ water [gal/min]					Max. tank diameter [ft]
		Connection							p [psi]					
		3/8" Female NPT	1/2" Female NPT	3/4" Female NPT	1" Female NPT	1/2" slip-on	3/4" slip-on		30	45	Liters per min. 3 bar	75	145	
180° 	5S6.963.1Y	BF	BH				TF05	0.07	6.80	8.33	31	10.75	14.95	11
	5S7.043.1Y		BH				TF07	0.08	10.97	13.43	50	17.34	24.11	13
	5S7.113.1Y		BH	BL			TF07	0.08	16.01	19.61	73	25.32	35.20	19
	5S7.183.1Y			BL			TF07	0.08	23.91	29.28	109	37.80	52.56	23
	5S7.223.1Y			BL			TF07	0.08	29.83	36.54	136	47.17	65.59	24
	5S7.253.1Y			BL	BN		TF07	0.08	36.19	44.33	165	57.23	79.57	26
180° 	5S6.964.1Y	BF	BH				TF05	0.07	6.80	8.33	31	10.75	14.95	11
	5S7.044.1Y		BH				TF07	0.08	10.97	13.43	50	17.34	24.11	13
	5S7.114.1Y		BH	BL			TF07	0.08	16.01	19.61	73	25.32	35.20	19
	5S7.184.1Y			BL			TF07	0.08	23.91	29.28	109	37.80	52.56	23
	5S7.224.1Y			BL			TF07	0.08	29.83	36.54	136	47.17	65.59	24
	5S7.254.1Y			BL	BN		TF07	0.08	36.19	44.33	165	57.23	79.57	26
270° 	5S6.965.1Y	BF	BH				TF05	0.07	6.80	8.33	31	10.75	14.95	11
	5S7.045.1Y		BH				TF07	0.08	10.97	13.43	50	17.34	24.11	13
	5S7.115.1Y		BH	BL			TF07	0.08	16.01	19.61	73	25.32	35.20	19
	5S7.185.1Y			BL			TF07	0.08	23.91	29.28	109	37.80	52.56	23
	5S7.225.1Y			BL			TF07	0.08	29.83	36.54	136	47.17	65.59	24
	5S7.255.1Y			BL	BN		TF07	0.08	36.19	44.33	165	57.23	79.57	26
270° 	5S6.966.1Y	BF	BH				TF05	0.07	6.80	8.33	31	10.75	14.95	11
	5S7.046.1Y		BH				TF07	0.08	10.97	13.43	50	17.34	24.11	13
	5S7.116.1Y		BH	BL			TF07	0.08	16.01	19.61	73	25.32	35.20	19
	5S7.186.1Y			BL			TF07	0.08	23.91	29.28	109	37.80	52.56	23
	5S7.226.1Y			BL			TF07	0.08	29.83	36.54	136	47.17	65.59	24
	5S7.256.1Y			BL	BN		TF07	0.08	36.19	44.33	165	57.23	79.57	26
360° 	5S6.969.1Y	BF	BH				TF05	0.06	6.80	8.33	31	10.75	14.95	11
	5S7.049.1Y		BH				TF07	0.08	10.97	13.43	50	17.34	24.11	13
	5S7.119.1Y		BH	BL			TF07	0.08	16.01	19.61	73	25.32	35.20	19
	5S7.189.1Y			BL			TF07	0.08	23.91	29.28	109	37.80	52.56	23
	5S7.229.1Y			BL			TF07	0.08	29.83	36.54	136	47.17	65.59	24
	5S7.259.1Y			BL	BN		TF07	0.08	36.19	44.33	165	57.23	79.57	26

BSPP thread available on request.

The maximum tank diameter applies to the recommended operating pressure and is meant as a recommendation only.

The cleaning result is also affected by the type of soiling.

Compressed air should be used for dry blowing for a short time only. Operation above the recommended operating pressure has a negative impact on the cleaning result and wear.

#### Information about slip-on connections

- Pin made of stainless steel 316L supplied (Ordering no.: 095.013.1Y.06.45).
- Depending on the diameter of the adapter, the flow rate can increase due to a leakage between the adapter and the rotating cleaning nozzle.